



OMNI

- Lutron compatible control systems.
 - EcoSystem digital control – dims down to 1%
 - 3-wire phase control – dims down to 1%
- 0-10V – dims down to 5%.
- DALI digital - dims down to 1%.
- Line voltage dimming (LVD) - 5%. 120V only for dimming.
- Retrofit for over 50% less than installing a new fixture.
- Simplest & safest way to achieve energy savings.
- Keep existing fixtures, controls, sensors and control system.
- No mess/fixture recycling. No need to break ceiling plane.
- Substantial maintenance and energy savings.
- Optimize local utility rebates.
- 32W & 42W Horizontal kits may not fit in all 6" cans; test-for-fit.
- Not for use in enclosed fixtures.



25W VERTICAL

12W VERTICAL

HORIZONTAL



G24Q 4-PIN BASE
(NOT INTENDED TO REPLACE
2-PIN G23 OR GX23 2-PIN LAMPS)



CFL/PL
G24Q BASE

KITS INCLUDE

- PAIR IT WITH A DRIVER AND ACCESSORIES



DRIVER



SERVICE DISCONNECT



LATCH CONNECTORS

WIRE KIT

CHOOSE YOUR LIGHT ENGINE



EXT DRIVER / LVD = 120V DIMMING ONLY



LUTRON ECOSYSTEM & 3-WIRE



10V DIM



CRI



PWR FACTOR/THD



32°F TO 104°F OPERATING TEMP



TYPE C RETROFIT

ETL CLASSIFIED



Intertek
5018068

CONTACT US FOR OTHER DRIVER TYPES.



PART NUMBER BUILDER

| MFR | TYPE | LUMINAIRE CONFIGURATION | # OF LAMPS | COLOR | DRIVER | CASE* | GEN | OPTIONS** |
|-----|------|--|------------|---|---|--|-----|--------------------|
| RP | G24Q | 126V 126H 132V 132H 142V 142H 226V 226H 232H 242H | 1L 2L | 830 = 3000K 835 = 3500K 840 = 4000K | E1 = LUTRON ECO SYSTEM 1DIMS DOWN TO 1% 3W = LUTRON 3 WIRE DIMS DOWN TO 1% 10V = 0-10V DIMMING DIMS DOWN TO 5% LVD = LINE VOLTAGE DIMMING (5% DIMMING TYPICAL. 120V/277V SWITCHED, 120V ONLY FOR DIMMING DA = DALI DIMS DOWN TO 1% | K = SQUARE W/ STUDS (NOT FOR USE W/ LVD 132V OR 132H CONFIGURATIONS) KN = SQUARE W/O STUDS M = LINEAR (NOT FOR USE W/ LVD 132V OR 132H CONFIGURATIONS) | G2 | -EMG -B -TAA |

EXAMPLE PART NUMBER RP-G24Q-126V-1L-830-3W-K-G2-EMG-B-AA

* SEE DIMENSIONS BELOW. ** SEE TABLE BELOW.

OPTIONS

| EMG | B | TAA |
|---|--|----------------------------|
| EMERGENCY BATTERY BACKUP Approximately 500 lumens for 90 minutes. Contact us for more options. | BULK PACK OPTIONS B24 = 1-lamp kit B12 = 2-lamp kit B8 = 3-lamp kit B6 = 4-lamp kit | TAA=CONTACT US FOR OPTIONS |

CFLs can be Mounted Horizontally or Vertically in Many Fixture Types
 Since luminaire designs vary by manufacturer and model, a mockup is suggested to confirm a proper fit.
 See page 4 for examples of common fixture types.

| EXISTING | 1L VERT 26W | 1L VERT 32W | 1L VERT 42W | 2L VERT 26W | 1L HORIZ 26W | 1L HORIZ 32W | 1L HORIZ 42W | 2L HORIZ 26W | 2L HORIZ 2x 32W | 2L HORIZ 2x 42W |
|-------------------|-----------------------------|-----------------------------|-----------------------------|-----------------------------|-----------------------------|----------------------------|-----------------------------|----------------------------|-----------------------------|-----------------------------|
| KIT PART #* | RP-G24Q-126V-1L-8XX-DD-C-G2 | RP-G24Q-132V-1L-8XX-DD-C-G2 | RP-G24Q-142V-1L-8XX-DD-C-G2 | RP-G24Q-226V-2L-8XX-DD-C-G2 | RP-G24Q-126H-1L-8XX-DD-C-G2 | RP-G24Q-132H-1L-8XX-DD-C-G | RP-G24Q-142H-1L-8XX-DD-C-G2 | RP-G24Q-226H-2L-8XX-DD-C-G | RP-G24Q-232H-1L-8XX-DD-C-G2 | RP-G24Q-242H-1L-8XX-DD-C-G2 |
| LAMP TYPE | OMNI | DIRECTIONAL | DIRECTIONAL | OMNI | DIRECTIONAL | DIRECTIONAL | DIRECTIONAL | DIRECTIONAL | NONE | DIRECTIONAL |
| KIT WATTAGE | 12W | 14W | 28W | 24W | 13W | 14W | 21W | 26W | 24W | 28W |
| KIT LUMENS | 900 | 1200 | 2700 | 1800 | 1000 | 1200 | 2000 | 2000 | 2400 | 2700 |
| LAMP DIMENSIONS | 6.8" x 1.3" | 3.0" x 3.8" | 4.2" x 3.7" | 6.8" x 1.3" | 5.8" x 1.4" | 3.0" x 3.8" | 4.2" x 3.7" | 5.8" x 1.4" | 3.0" x 3.8" | 4.2" X 3.7" |
| INCLUDED ADAPTER | NONE | NONE | NONE | NONE | NONE | 7317 | 7317 | NONE | 7317 | 7317 |
| OPTIONAL EXTENDER | N/A | 7319 | 7319 | N/A | N/A | N/A | N/A | N/A | N/A | N/A |



*See part number builder on pg. 2 for final part numbers



DRIVER DIMENSIONS

LUTRON

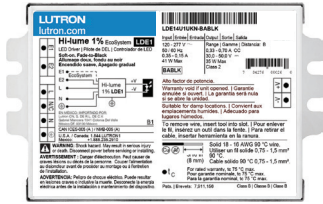

CASE TYPE K

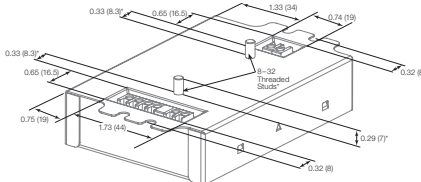

K CASE CONNECTOR LOCATIONS (WITH STUDS)

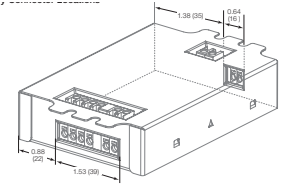

KN CASE SIDE ENTRY CONNECTOR LOCATIONS (WITHOUT STUDS)



CASE TYPE M

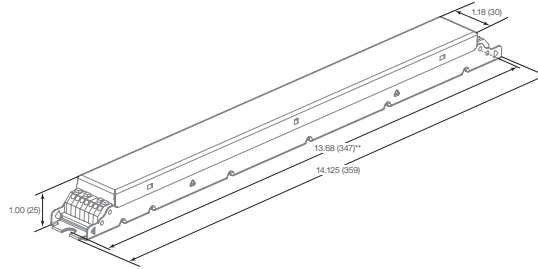

LVD

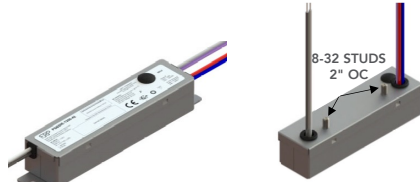

M CASE

K CASE

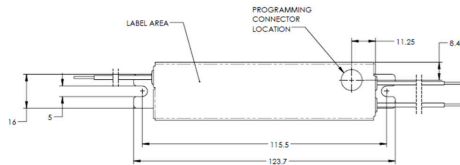

M CASE

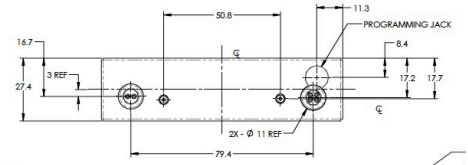

K CASE



KN CASE
25W SYSTEM MAX

KN CASE
26 TO 60W SYSTEM MAX

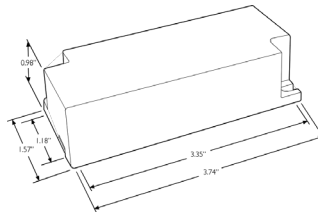

KN CASE 25W SYSTEM MAX

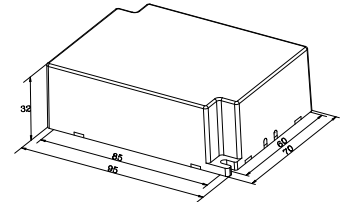

KN CASE 26W TO 60W SYSTEM WATTAGE

NOTE It is important that LVD drivers are mounted to a flat metal surface in order to maximize service life.

10V

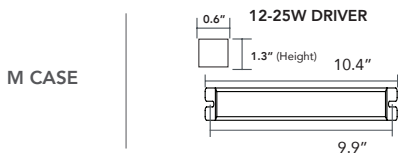

M CASE

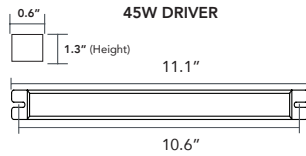
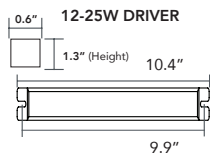

45W DRIVER

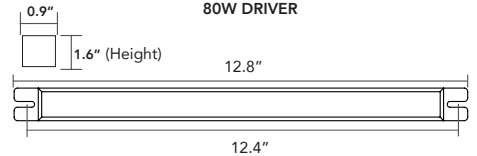
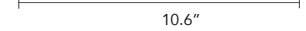

80W DRIVER

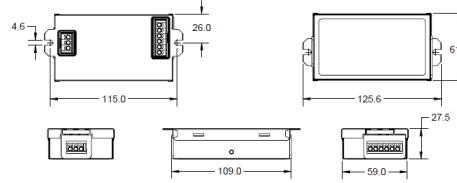
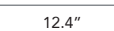

KN CASE

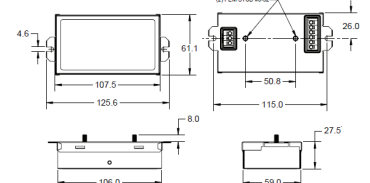

K CASE



EMG INFORMATION

4W ALL IN ONE EMG

EXISTING G24Q LAMPS WILL LIGHT IN EMG MODE
Approximately 500 lumens for 90 minutes.
Contact us for more options

DRIVER



EMG DIMENSIONS: 5.34" x 1.69" x 1.01"
(SEE LINE DRAWING BELOW)
SEE EXAMPLE 1 BELOW FOR WIRING DIGRAM

LINE DRAWING

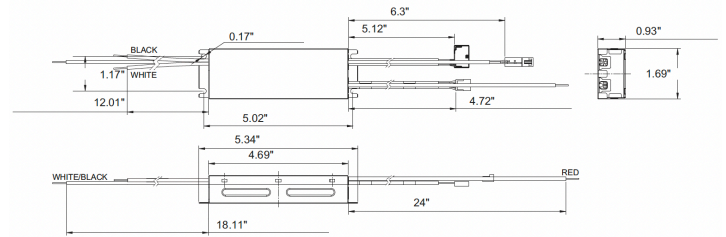

WIRING DIAGRAM

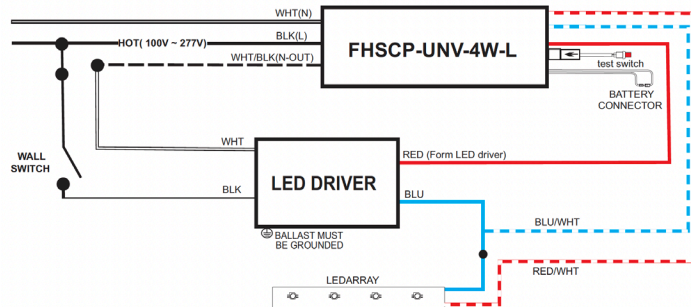

MOST COMMON FIXTURE TYPES



HORIZONTAL
2-LAMP DOWNLIGHT ORIENTATION



VERTICAL
1-LAMP DOWNLIGHT ORIENTATION



PENDANT
1 OR 2-LAMP UPLIGHT/DOWNLIGHT ORIENTATION



SCONCE
1 OR 2-LAMP VERTICAL ORIENTATION

FOR MORE INFORMATION VISIT C-FLEXRETROFITS.COM

